

Brunswick Dart Cabinet Mounting Instructions:

Step 1:

Locate 2 studs in wall for attachment of supplied "Wall Cleat".

Attach the cleat with the bottom edge located at 72".
(Screws are NOT provided)

Note: Top of the cleat should angle up and away from the wall.

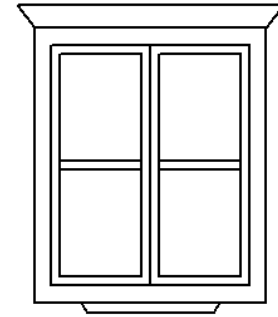

Step 2:

Hang cabinet on wall cleat.

Bottom of cabinet should be 48" + or - from floor once in position.

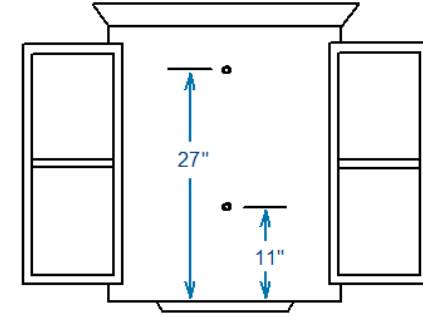

Step 3:

If mounting the Arachnid Cricket Pro 425 or Pro 800...
Measuring up from the floor of the cabinet and install 2 mounting screws at the locations listed above.
(Screws are provided with the Arachnid dart boards)

Note:

You will need to drill a 3/8" hole for the power cord.
This typically is placed in either the lower left or lower right corner of the floor of the cabinet...depending on where your electrical outlet is located.

Tools needed: Level, cordless drill, 3/16" & 3/8" drill bits, screw tip.

Supplies needed: Screws to mount wall cleat to wall surface.